

# Fantasea Line

## UCL-900F +15 Super Macro Lens

(Cat. No. 5118)

### Instruction Manual

The **UCL-900F +15 Super Macro Lens** is perfect for shooting super macro images of fish, corals, texture and more. It magnifies the subject and enables the camera to focus on tiny, nearby objects, creating unique and sharp images. The **UCL-900F +15 Super Macro Lens** is a “wet” lens that fits onto the housing lens port and can be installed and removed during the course of the dive.

#### SPECIFICATIONS

- +15 diopter close-up lens
- Hard anodized aluminum Bezel
- Lens construction: 2 groups and 5 elements
- Lens coating: AR multi layer coating
- Threads (rear and front): 67mm
- Dimensions: 70 x 38.6 mm / 2.7 x 1.5 inch
- Weight (on land): 270.5 g / 9.5 oz
- Weight (underwater): 170 g / 6 oz
- Included in package: Front and rear lens covers, lens pouch, Velcro secure strap, secure string and microfiber cloth
- Depth rated to 60 meters / 200 feet



#### INCLUDED IN PACKAGE

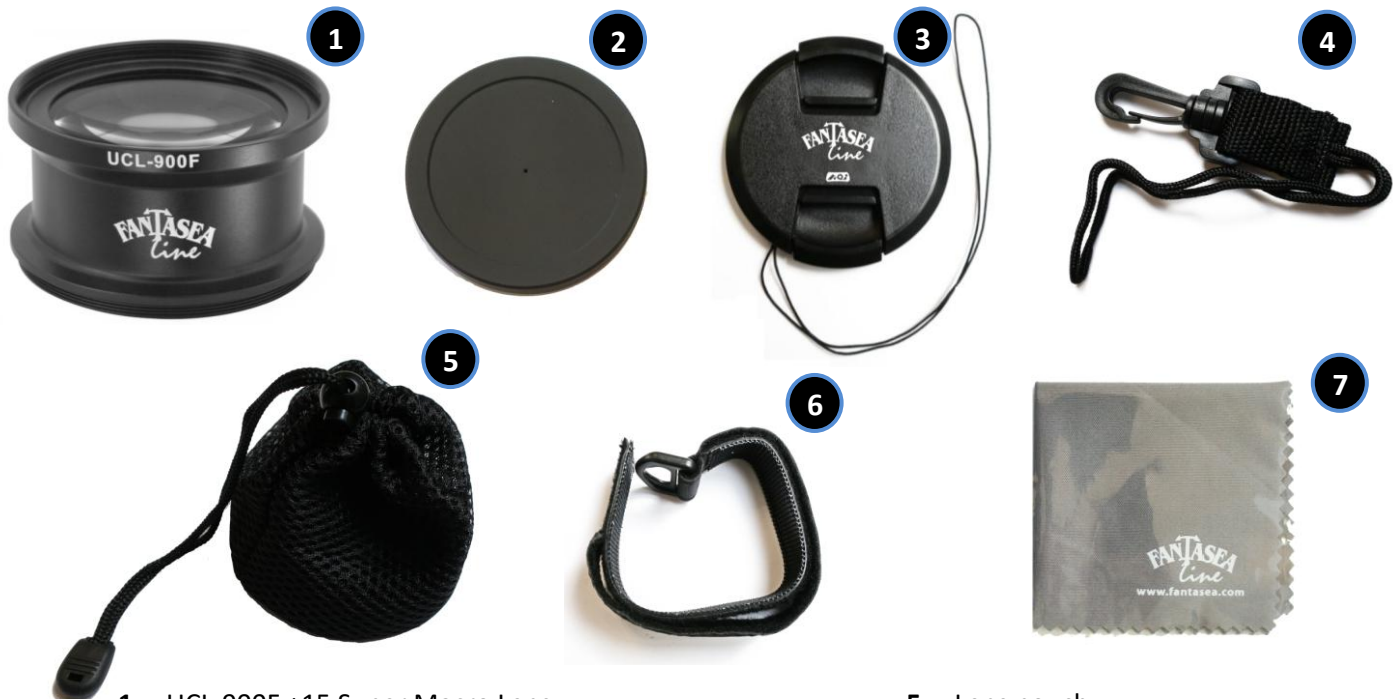

1. UCL-900F +15 Super Macro Lens
2. Rear cap
3. Front cap
4. Secure string

5. Lens pouch
6. Velcro secure strap
7. Microfiber cloth

## COMPATIBILITY

The **UCL-900F +15 Super Macro Lens** can be mounted on 67mm threaded lens ports or other lens ports by using an adaptor. For a selection of adaptors available, please visit our website - [www.fantasea.com](http://www.fantasea.com)

## INSTRUCTIONS FOR USE

1. Install the secure string on the lens:
  - a. Wrap the Velcro secure strap around the lens starting with the end featuring the Velcro, having the Velcro facing out of the lens (image #1).
  - b. Continue until the strap is wrapped around itself and the Velcro attaches (image #2).
  - c. Install the secure string by inserting it through the lanyard loop on the Velcro secure strap, then pulling it through itself and testing it in order to make sure it is secure (image #3).



2. It is recommended to attach the secure strings of the lens and front cap to the housing, in order to secure them. If making use of an arm in the system, secure strings can be secured to the arm rather than to the housing.
3. Unscrew the rear cap of the lens until it can be removed.
4. It is recommended to apply a small amount of silicone grease on the threaded area in order to prevent corrosion. Make sure that no grease is applied over the lens glass.

5. If an adaptor ring is required in order to attach the super macro lens to your housing lens port, attach the adaptor to the macro lens by screwing it in.
6. During the dive, install the super macro lens by screwing it on to your housing lens port. Avoid tightening the lens too hard onto the housing port, filter or adaptor, as this might result in difficulty with removal.
7. **Please note that the UCL-900F +15 Super Macro Lens was designed to work underwater only.** Therefore, the lens should only be installed underwater, while letting water enter the gap between the super macro lens and the housing lens port. Make sure that there are no air bubbles trapped between the accessory lens and the housing lens port.
8. **For best results with the super macro lens installed, it is recommended to set your camera focus mode to "MACRO" and to zoom in with the camera lens.**
9. The lens features a front thread which allows for stacking additional lenses and/or filters.
10. The lens can be removed and installed repeatedly throughout the course of the dive.
11. When removing the lens from the housing lens port, it can be secured by attaching it to a Lens Holder, which mounts on any standard Flex or B&J Arm. For a selection of Lens Holders available, please visit our website - [www.fantasea.com](http://www.fantasea.com)
12. After the dive, detach the super macro lens and all components from the housing lens port and rinse them in fresh water.
13. Dry and store in a safe protected place.

## CARE & MAINTENANCE

1. Please use the utmost care and do not use excessive force when assembling and disassembling the different lens accessories, in order not to cause any damage to the products.
2. Keep the lens away from extreme high temperatures, as under direct sunlight, since it might damage the lens.
3. Do not clean the lens with any chemical solvents or other materials, which might cause damage to the lens.
4. Never look at the sun through the lens.
5. After the dive, rinse all lens components in fresh water. To ensure that the accumulated salt has completely dissolved, it is recommended to soak the lens in warm fresh water once in a while. Wipe the water drops with a soft cloth. Do not leave any droplets to dry on lens surface, as permanent water spots may remain.
6. When storing the lens and during transportation, make sure that it is properly protected in order to prevent scratches, cracks or any other damage to the lens.
7. Do not store the lens in presence of chemicals, solvents or fuels.
8. When mounting the lens on a housing lens port, it is recommended to follow the guidelines below in order to avoid wearing out the threads of the lens and housing over time:
  - a. Prior to installing the lens on the housing, it is recommended to apply a small amount of silicone grease on the threaded area of the lens (and adaptor, if used) to reduce the amount of friction.
  - b. Install the lens on the housing lens port underwater only and remove it prior to ending the dive. Once removed, the lens can be mounted on a lens holder. Avoid having the lens



assembled on the housing on land as much as possible, as it is heavier and exerts more pressure on the threads.

- c. It is recommended to reduce wearing of the threads by using lens mounting accessories such as bayonet mounts or flip adaptors.

## FANTASEA PRODUCT CONSUMER LIMITED WARRANTY

“Fantasea” warrants this Fantasea Line branded product against defects in materials and workmanship under reasonable use for a period of ONE (1) YEAR, (two years, where required by law as determined by the origin of the authorized dealer). This warranty is effective from the date of retail purchase from Fantasea or an authorized Fantasea dealer, by the original end-user purchaser (“Warranty Period”). This warranty does not cover any commercial use of the product. If a product defect arises and a valid claim is received within the Warranty Period, at its option, Fantasea, or its authorized service facilities will either (1) repair the product defect at no charge, (2) exchange the product with a product that is new or which has been manufactured from new or serviceable used parts and is at least functionally equivalent to the original product. The warranty will not extend beyond the original warranty period. Your Fantasea Product should be registered within 30 days of purchase. You must keep the proof of purchase which indicates the date on which the purchase was made; as you may be required to show proof of purchase if you need warranty service. The following conditions apply:

1. This warranty extends to the original purchaser only. It is not assignable or transferable. 2. The warranty does not cover damage resulting from misuse, abuse, negligence, or accidents. Proper maintenance of the Product is the responsibility of the owner. 3. The warranty does not cover damage directly or indirectly resulting from the use of unauthorized replacement parts or service performed by unauthorized facilities. 4. This warranty does not cover any damage to any other product used in conjunction with the Fantasea product, including cameras and lenses, and resulting from any defect in the product materials or workmanship. 5. The cost of sending the product back to Fantasea or its authorized service facilities is the responsibility of the customer. 6. The warranty does not cover any incidental damages resulting from any defects in the product. This expressly includes any travel reimbursements or any other costs associated with the purchaser’s optional use of the product. The conditions of this warranty are expressly in lieu of all other expressed warranties, including the payment of consequential or incidental damages for the breach of any warranty. Please register your product on line at this URL: <http://www.fantasea.com/registration>.

For further information, please contact us at [info@fantasea.com](mailto:info@fantasea.com) or visit our website [www.fantasea.com](http://www.fantasea.com)